



Full Onboarding with App and Multimedia- Guide



INTRODUCTION

Stay connected with your vehicle by using the new MyToyota app in 4 easy steps:

1. Download the MyToyota app and register.
2. Link the app to your vehicle.
3. Activate our digital services.
4. Pair your phone with the multimedia.



1. DOWNLOAD THE MYTOYOTA APP AND REGISTER

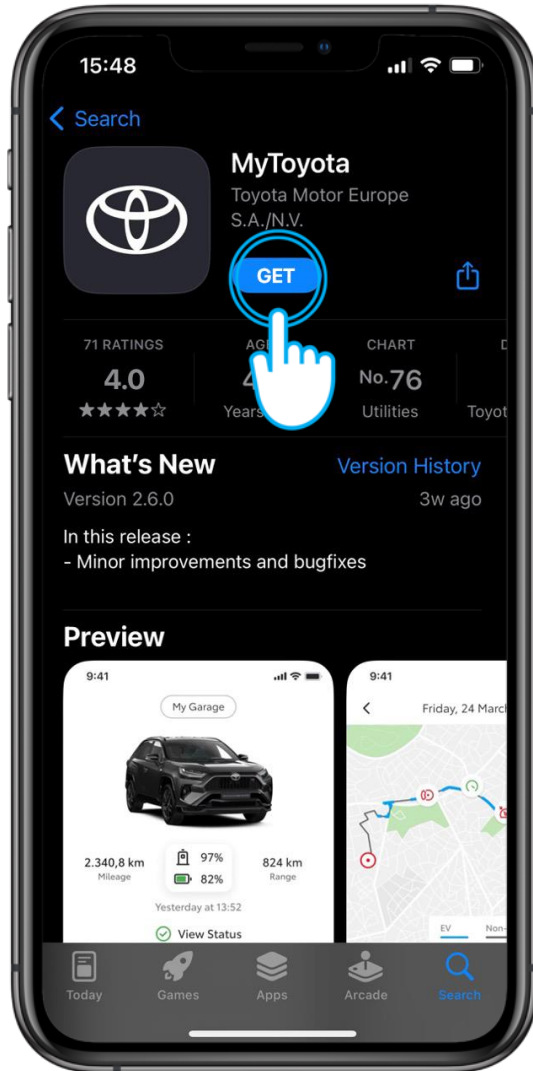

STEP 1

Start by downloading the latest MyToyota app.

In the App Store...

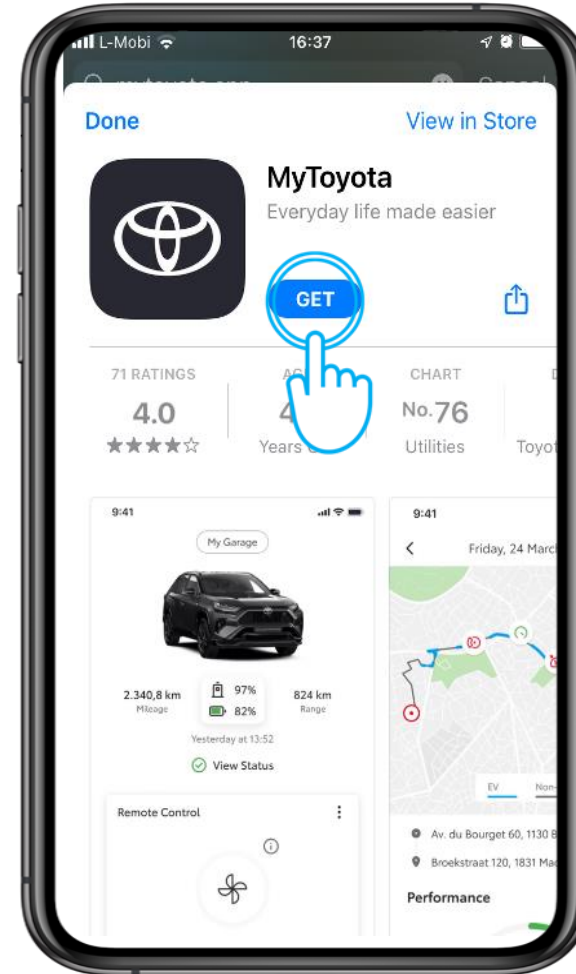

or from the Google Play Store.



1. DOWNLOAD THE MYTOYOTA APP AND REGISTER

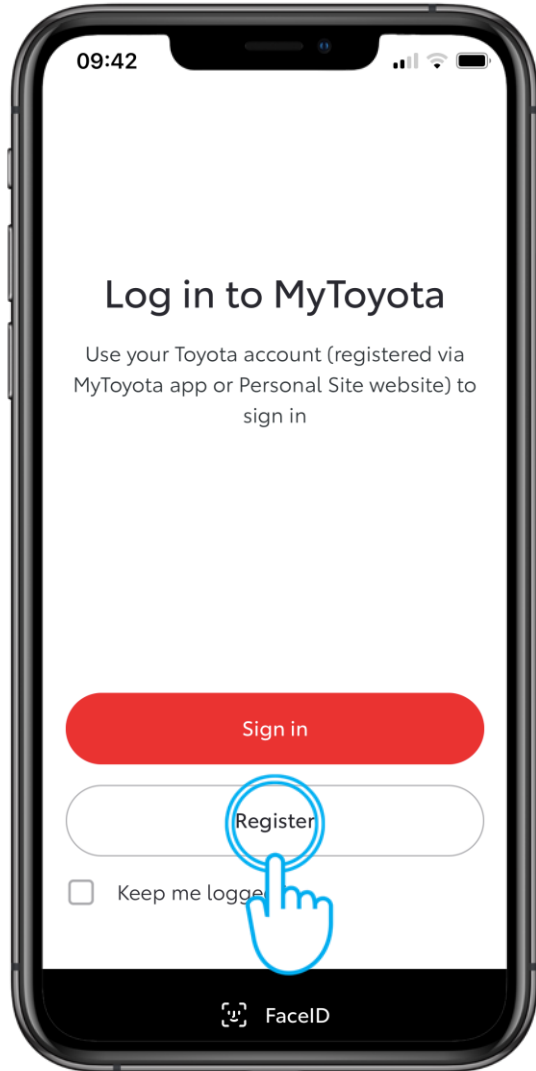

STEP 2

Tap "Register".

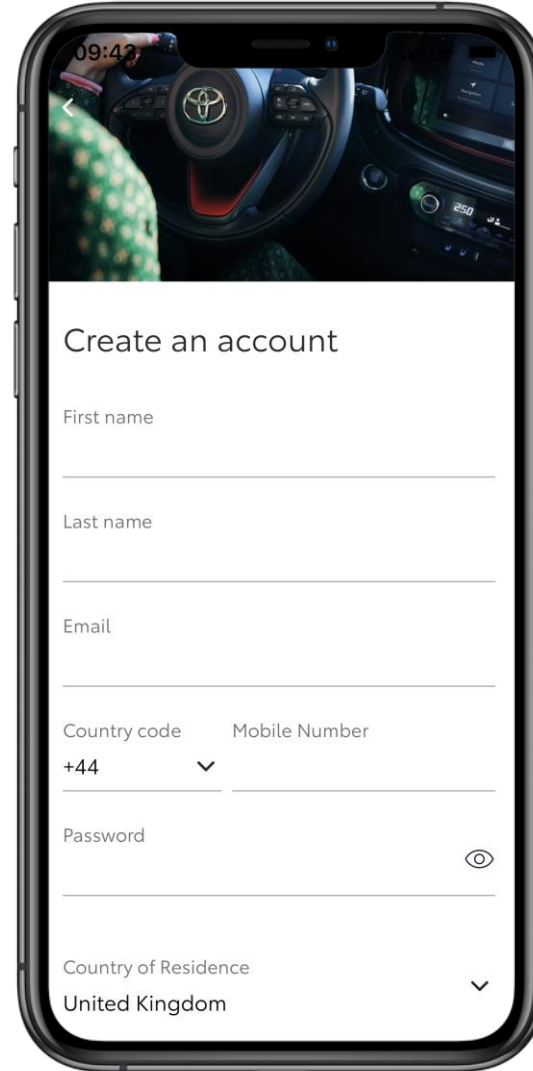

STEP 3

Fill in your details to create an account.



1. DOWNLOAD THE MYTOYOTA APP AND REGISTER

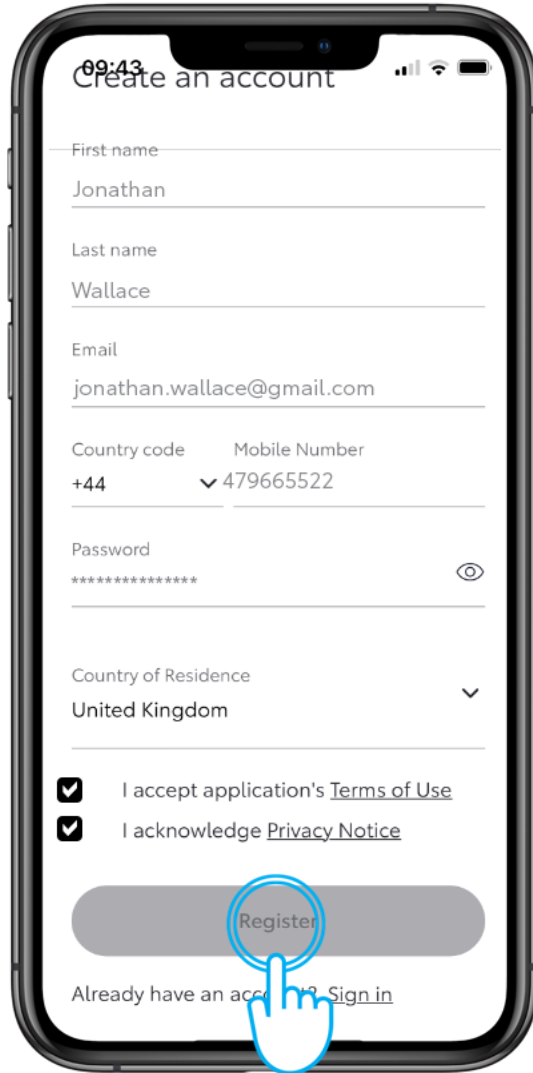

STEP 4

Tap on "Register".

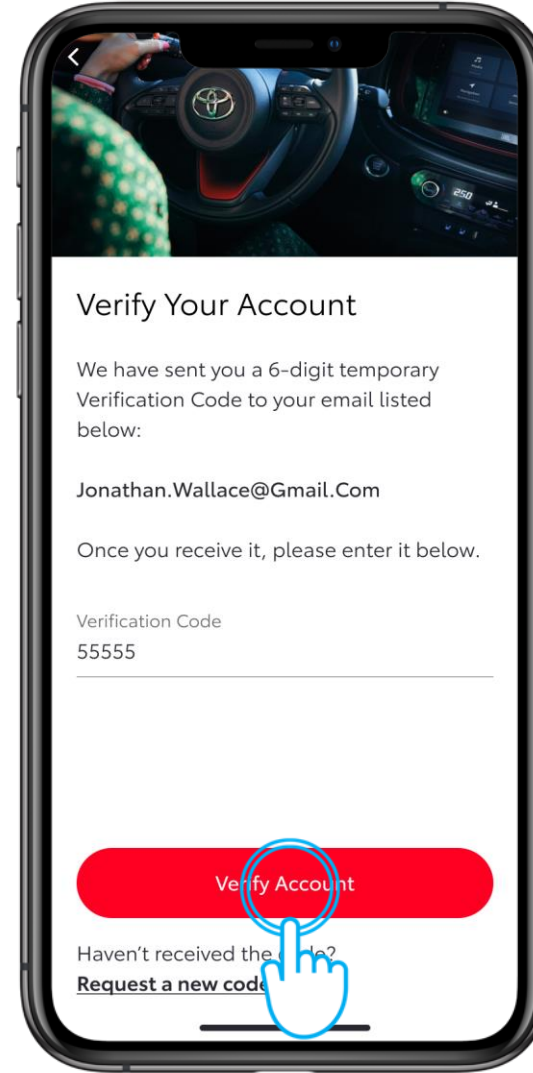

STEP 5

Verify your account by entering the 6-digit verification code sent via email and tapping "Verify Account".



2. LINK THE APP TO YOUR VEHICLE

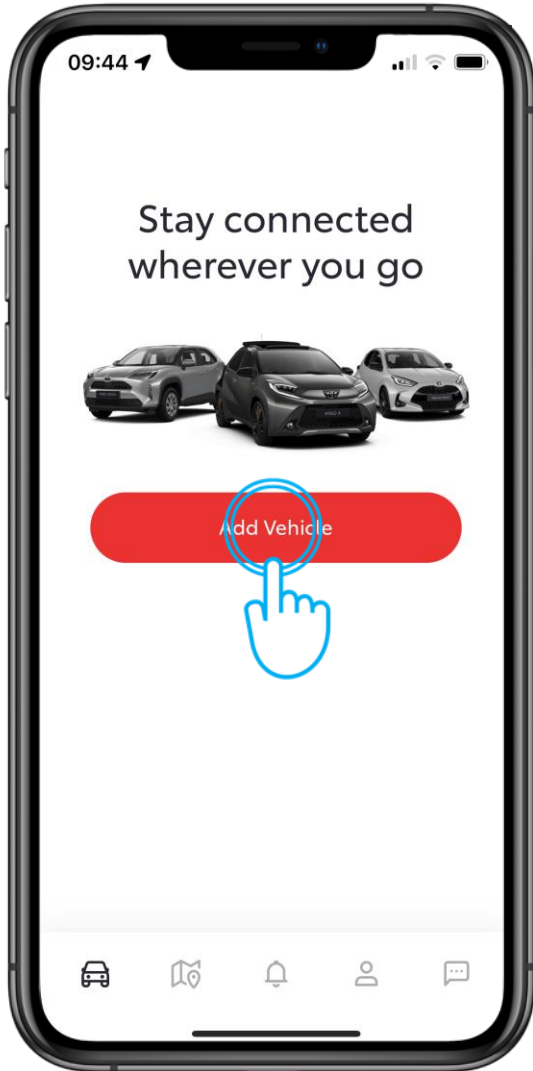

STEP 1

The next step is to add your vehicle to your account.

Tap on "Add Vehicle".

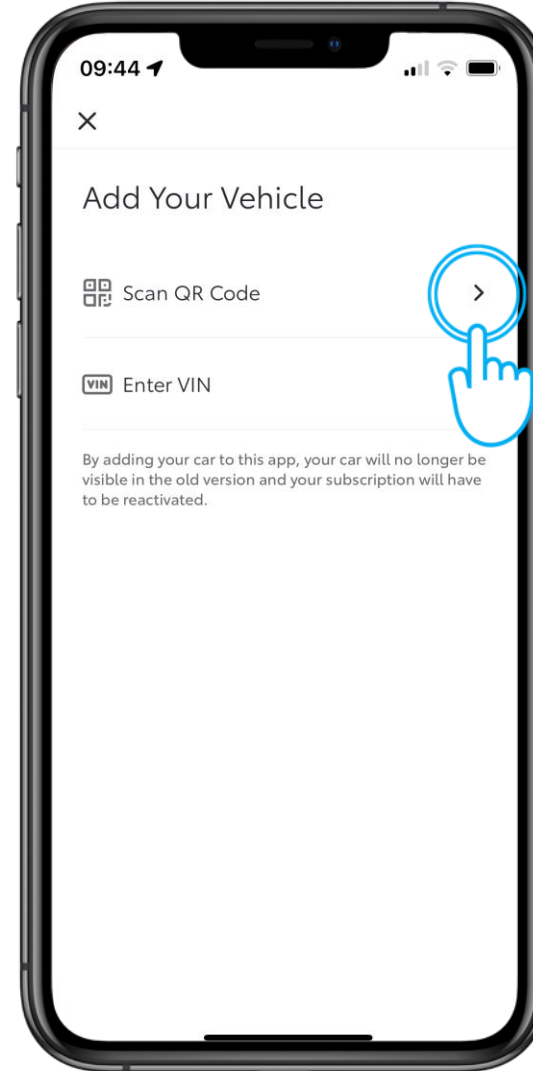

STEP 2

Tap on "Scan QR Code" and follow the process*.

**Or alternatively for older models, enter the VIN.*



2. LINK THE APP TO YOUR VEHICLE

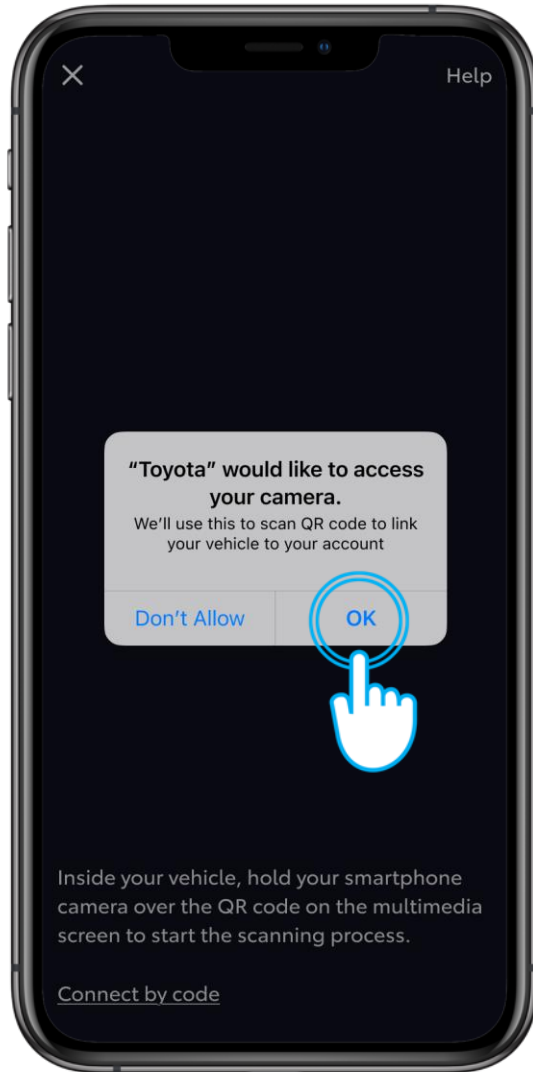

STEP 3

Allow the app to access your camera.

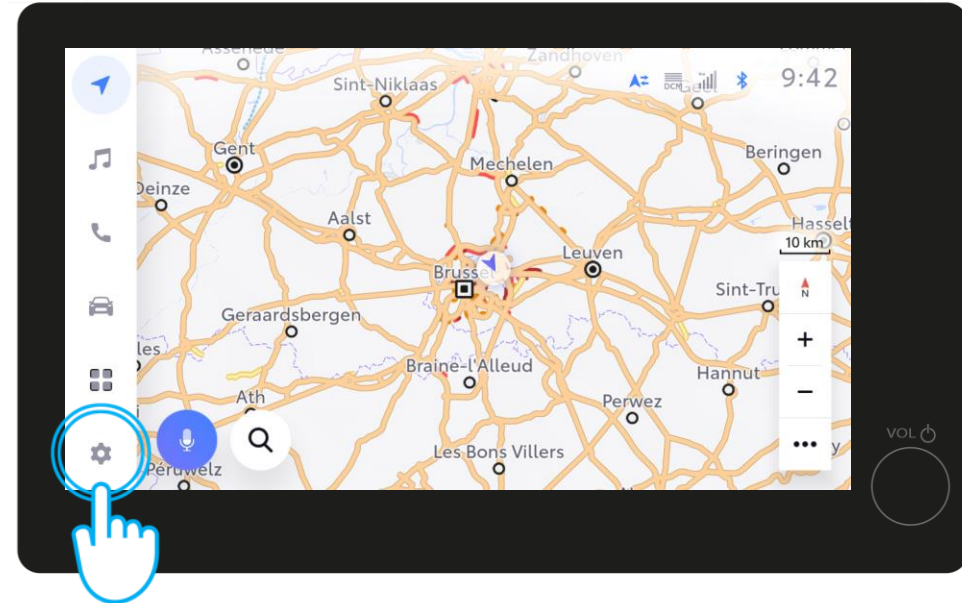

STEP 4

In your vehicle's multimedia, tap on "Settings".



2. LINK THE APP TO YOUR VEHICLE

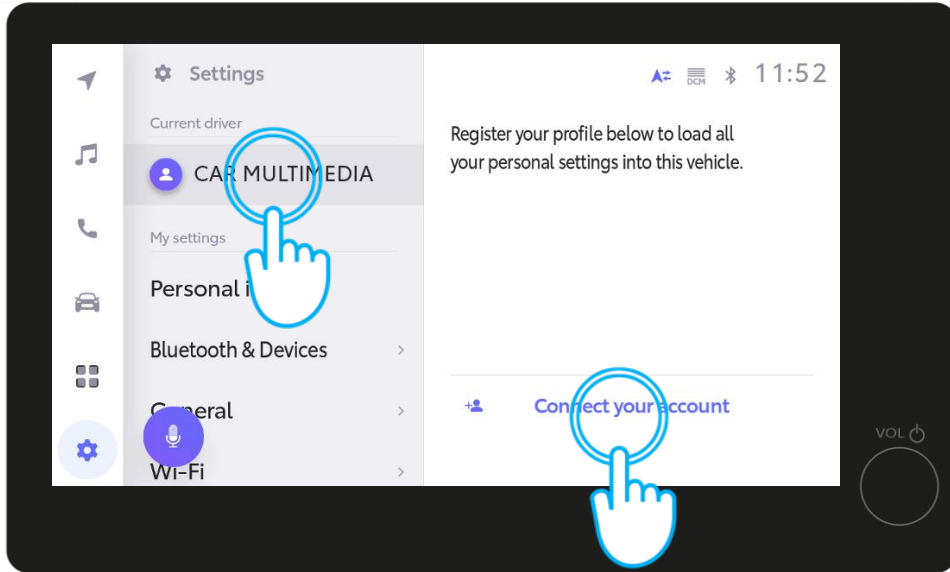

STEP 5

Tap on “Current driver” and then “Connect to your account”.

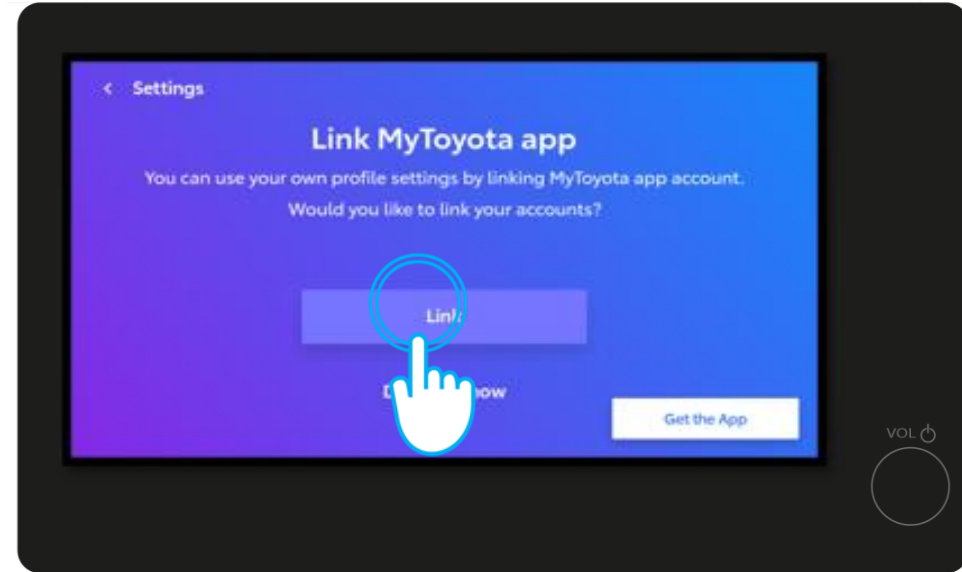

STEP 6

Tap on “Link”.



2. LINK THE APP TO YOUR VEHICLE

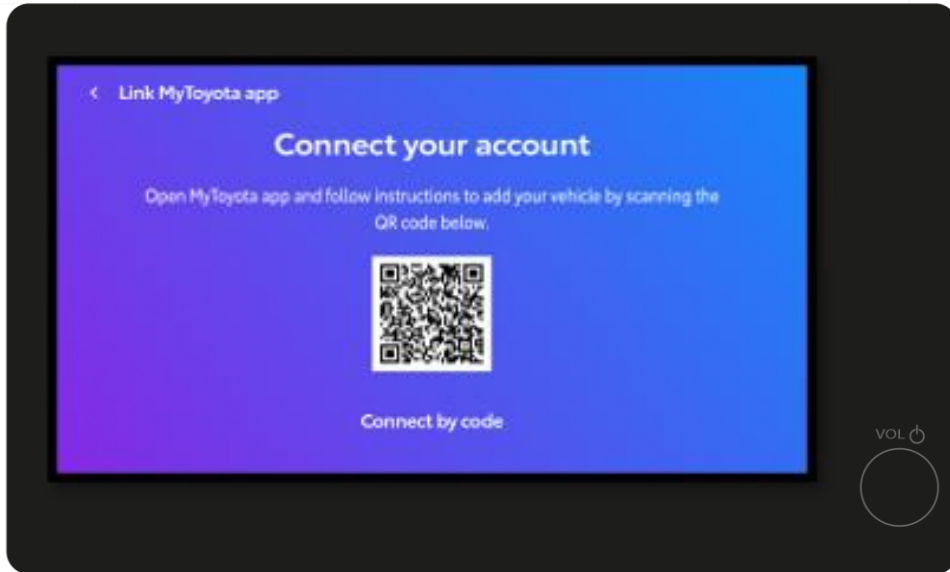

STEP 7

Scan the QR code with your MyToyota app.

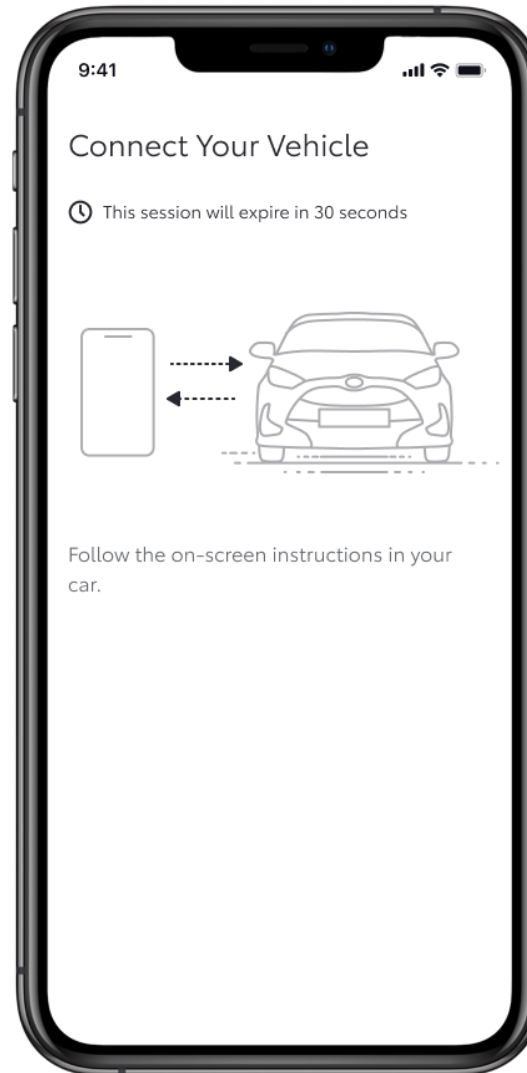

STEP 8

The app will display the progress.



2. LINK THE APP TO YOUR VEHICLE

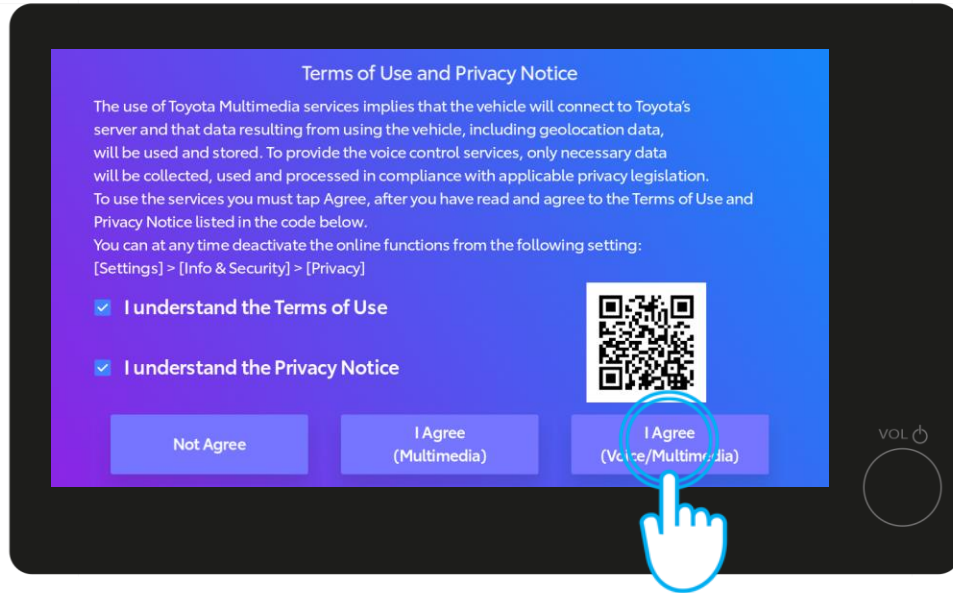

STEP 9

Once scanned, agree to the Voice/Multimedia Terms of Use and Privacy Notice in the multimedia screen. And tap on "I Agree".

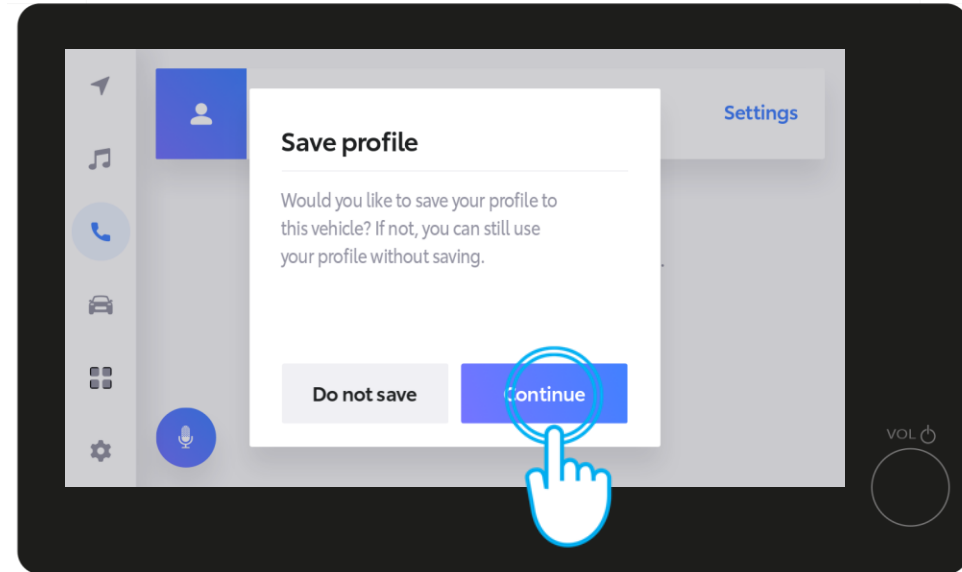

STEP 10

Tap Continue to save your profile...



2. LINK THE APP TO YOUR VEHICLE

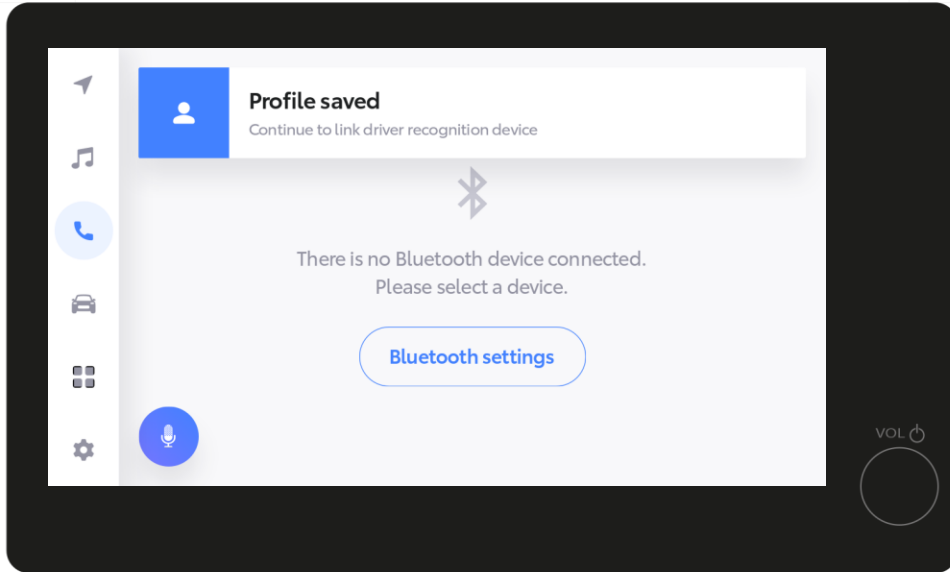

STEP 11

Profile saved will be displayed on the multimedia screen

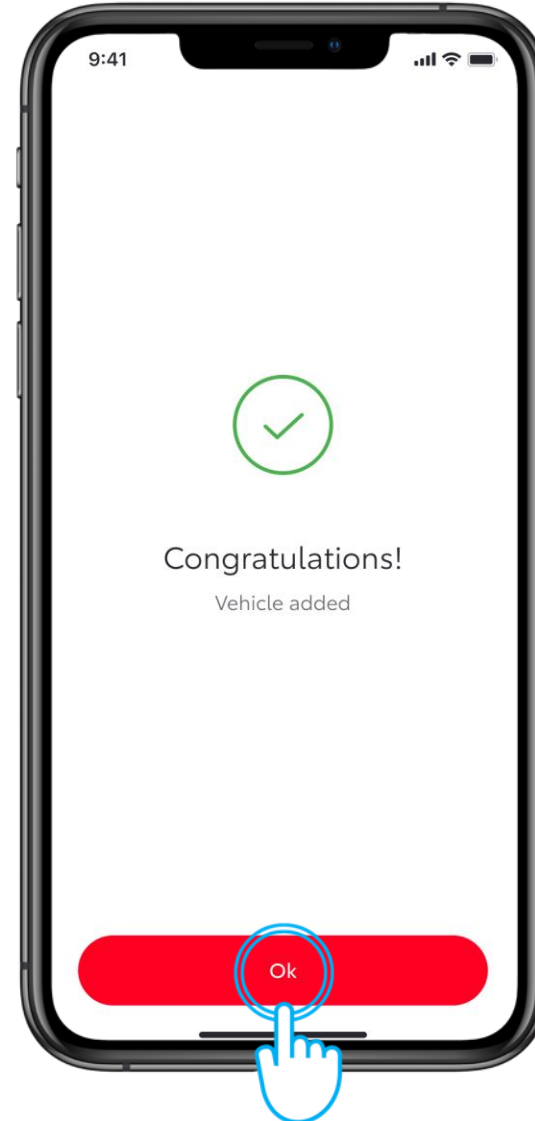

STEP 12

Tap "OK" in the app.



2. LINK THE APP TO YOUR VEHICLE

STEP 13

Your vehicle is now added to your app profile.

Tap "Save Changes".

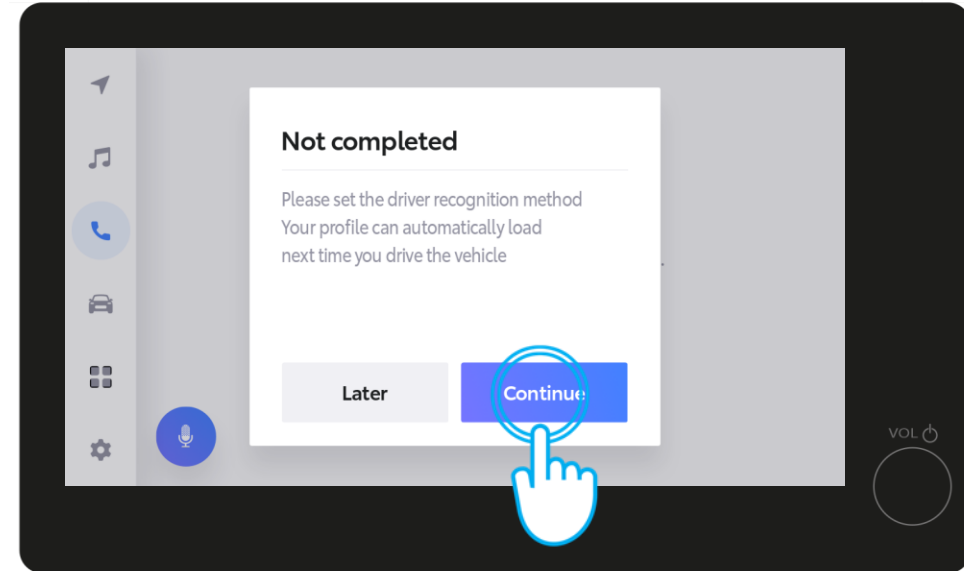
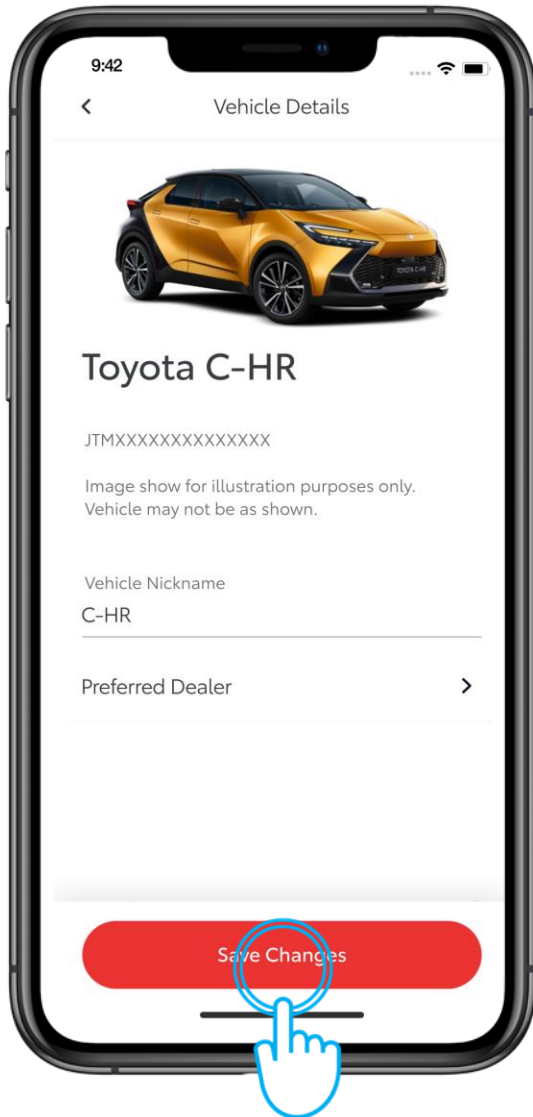

The multimedia screen will show that the process is not yet complete. Tap on "Continue".



3. ACTIVATE OUR DIGITAL SERVICES

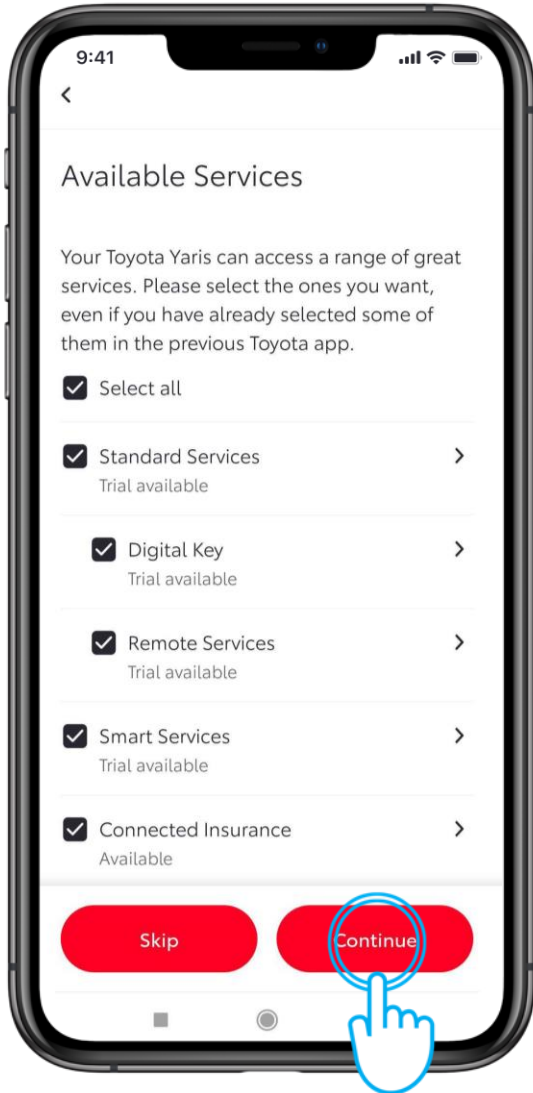

STEP 1

In the next step, select preferred connected services.

Read more about their benefits by tapping onto the arrows and once ready, tap on "Continue" to subscribe to them.

Availability of connected services may differ per model and country.

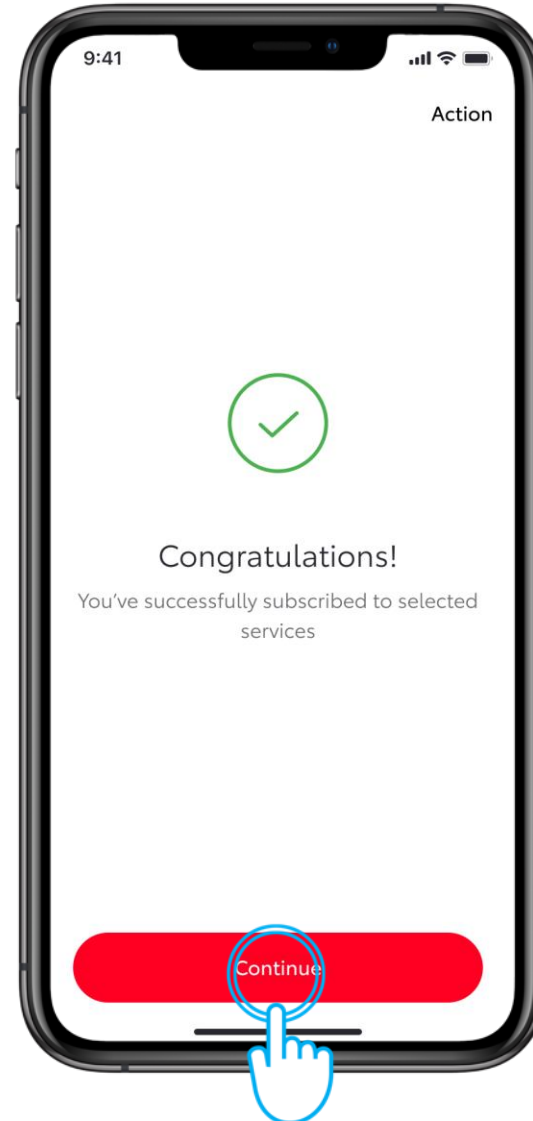

STEP 2

Tap on "Continue".



3. ACTIVATE OUR DIGITAL SERVICES

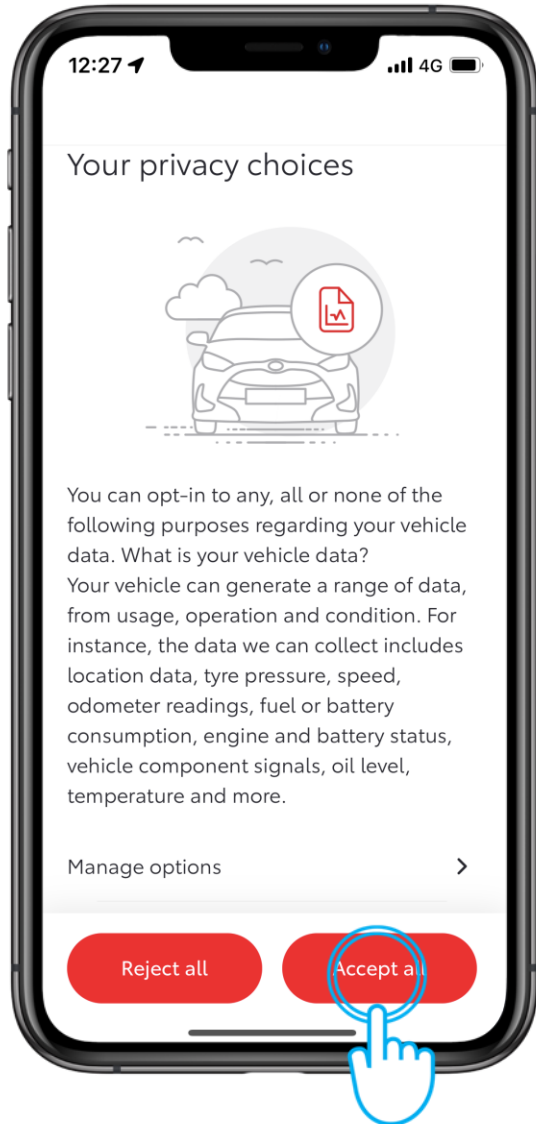

STEP 3

Lastly, before heading back to the vehicle multimedia screen, allow us to use your data to improve our services and take care of your safety, by specifying your preferred privacy choices.

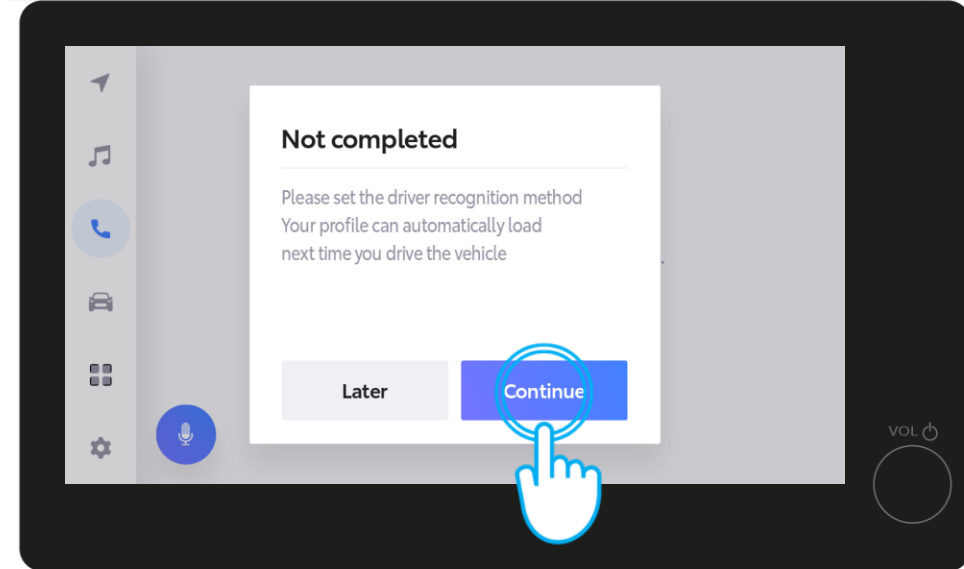

STEP 4

Back in the multimedia, tap on "Continue" to finish setting up your driver recognition method to ensure your profile automatically loads next time you drive the vehicle.



4. PAIR YOUR PHONE WITH THE MULTIMEDIA

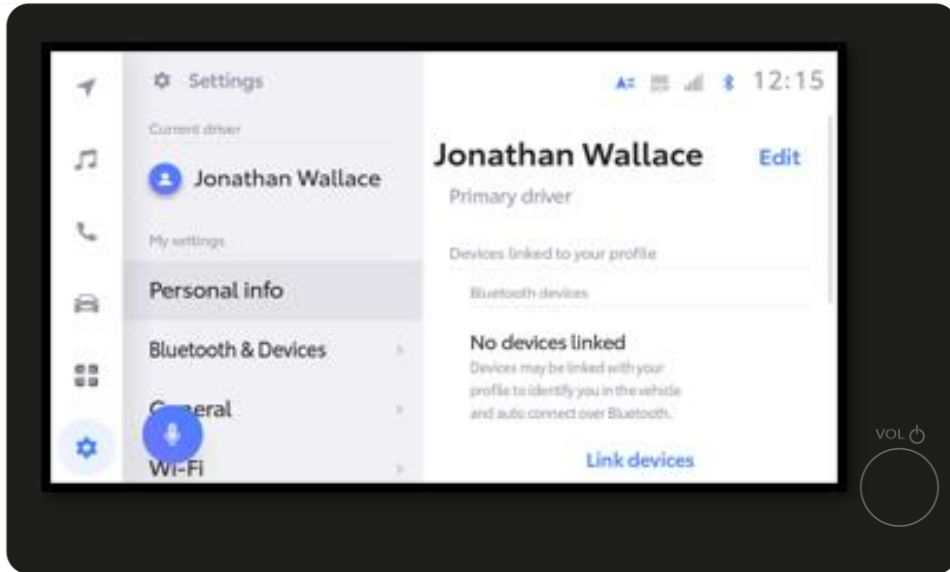

STEP 5

You will briefly see the settings page....

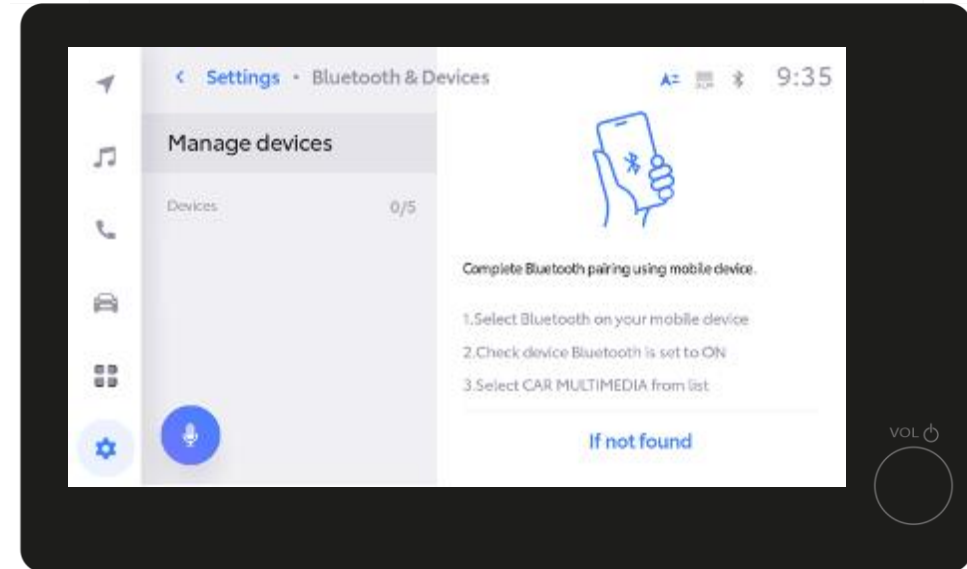

STEP 6

Followed by "Manage devices".



4. PAIR YOUR PHONE WITH THE MULTIMEDIA

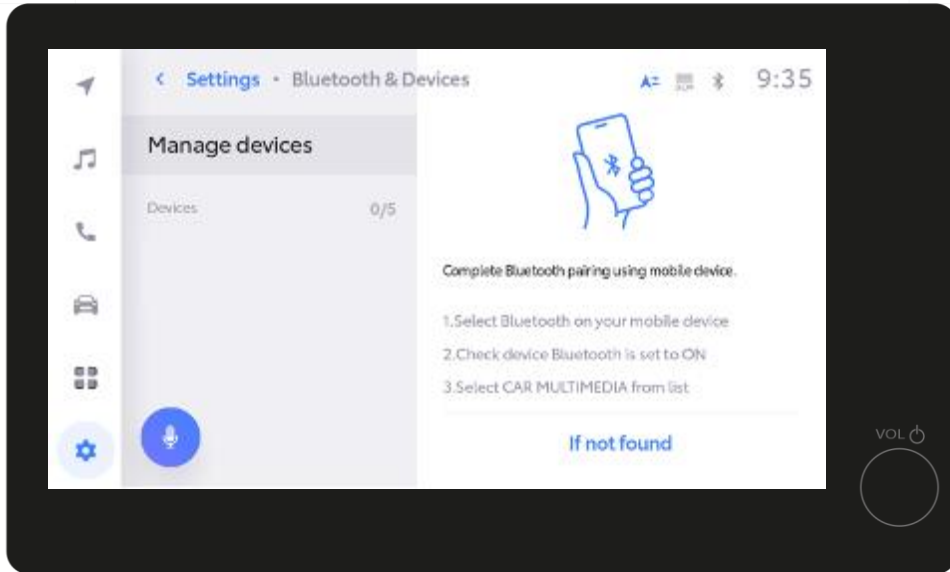

STEP 6 Continued

Manage devices will be shown in the multimedia.

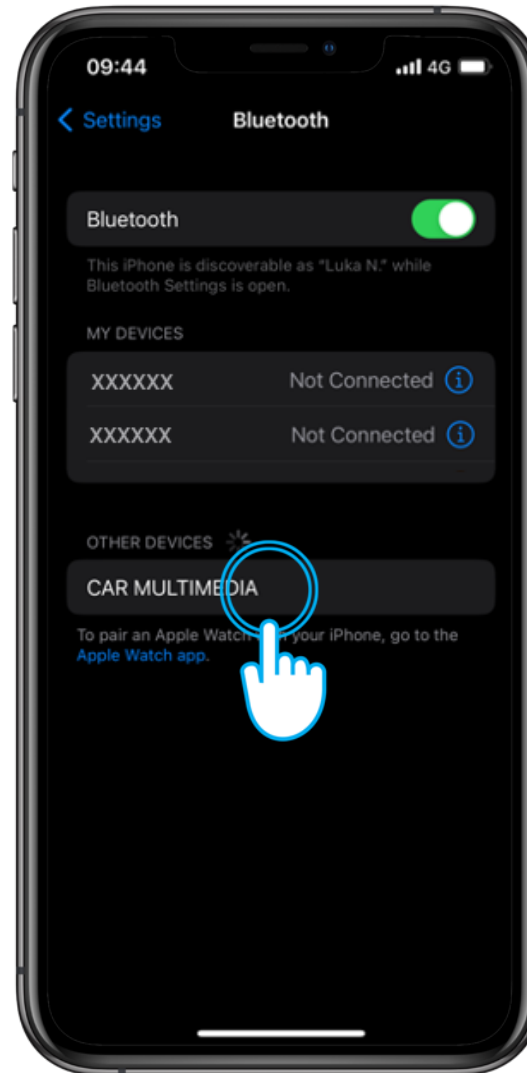

STEP 7

Open your phone's Bluetooth settings and pair it with Car Multimedia.

Ensure your Bluetooth is on and discoverable to others



4. PAIR YOUR PHONE WITH THE MULTIMEDIA

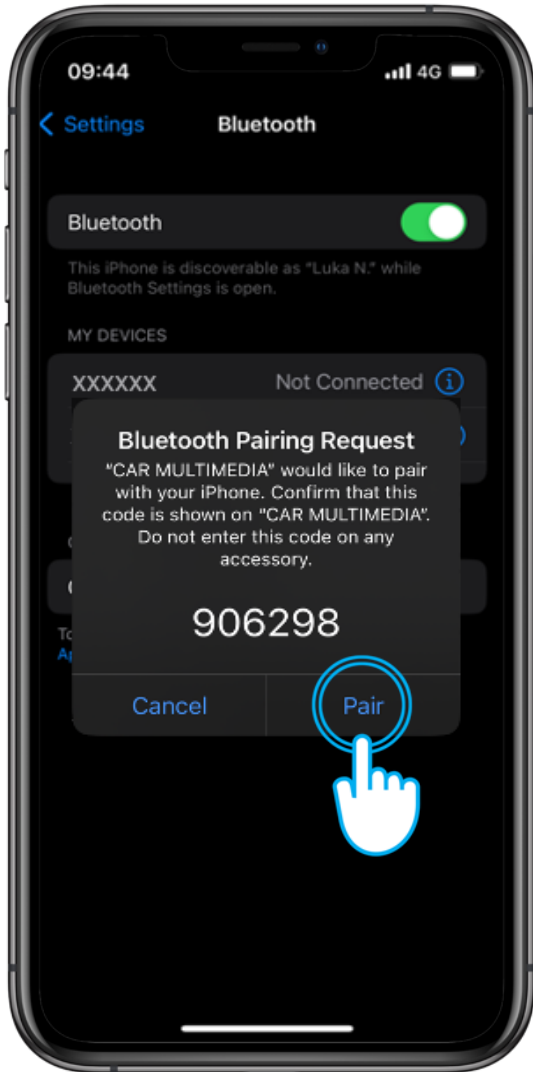

STEP 8

Tap Pair on your phone...

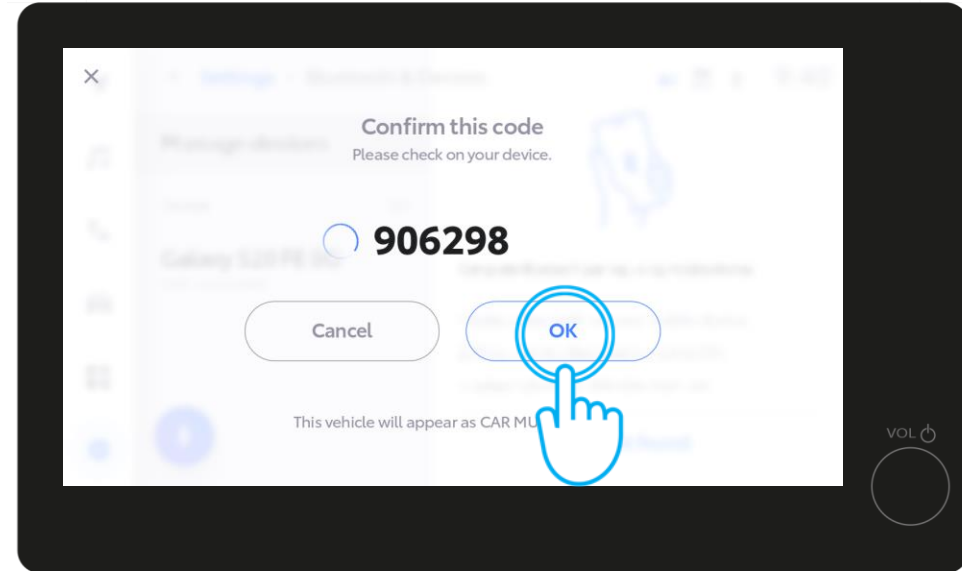

and OK in the vehicle multimedia.



4. PAIR YOUR PHONE WITH THE MULTIMEDIA

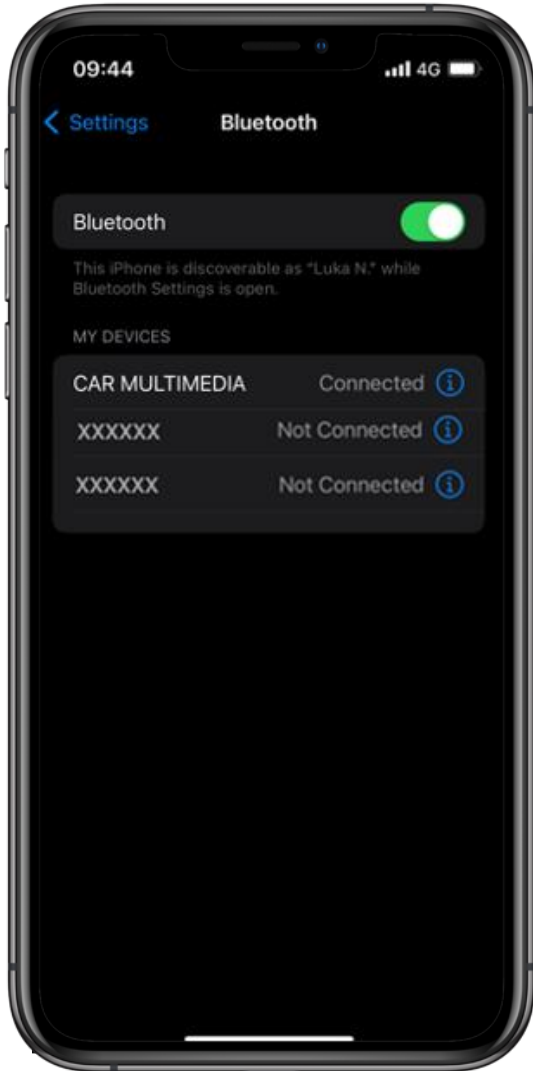

STEP 9

Set your phone as primary device...

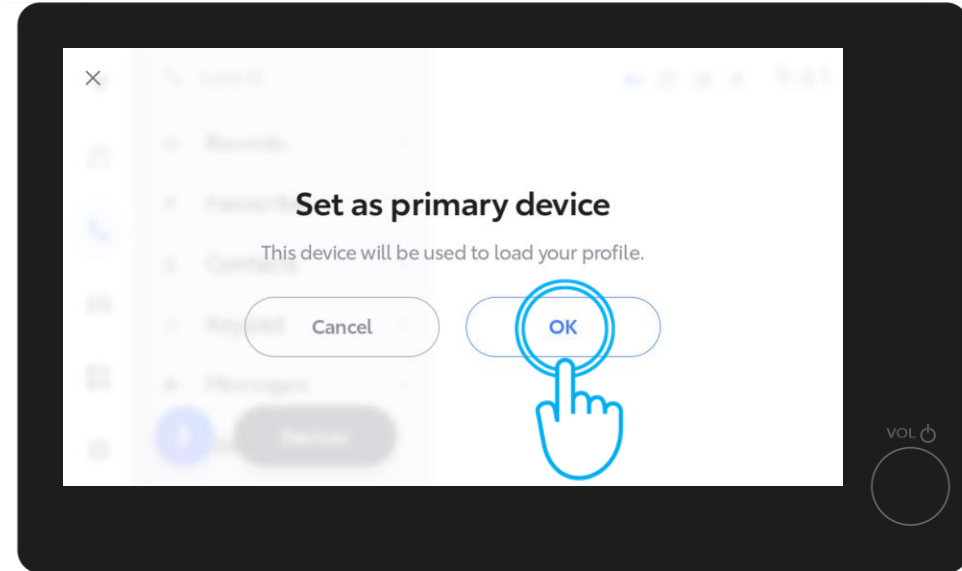

by tapping "OK" in the multimedia.

You can enable Apple CarPlay / Android Auto at this point to get access to your phone applications.



4. PAIR YOUR PHONE WITH THE MULTIMEDIA

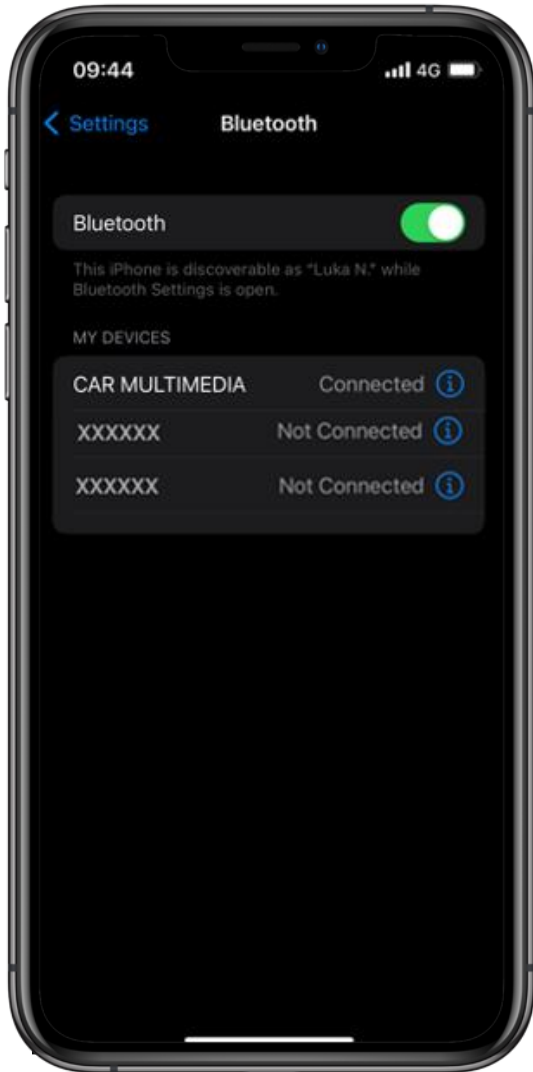

STEP 10

Now you are fully connected and ready to enjoy the benefits of the MyToyota app and multimedia features.

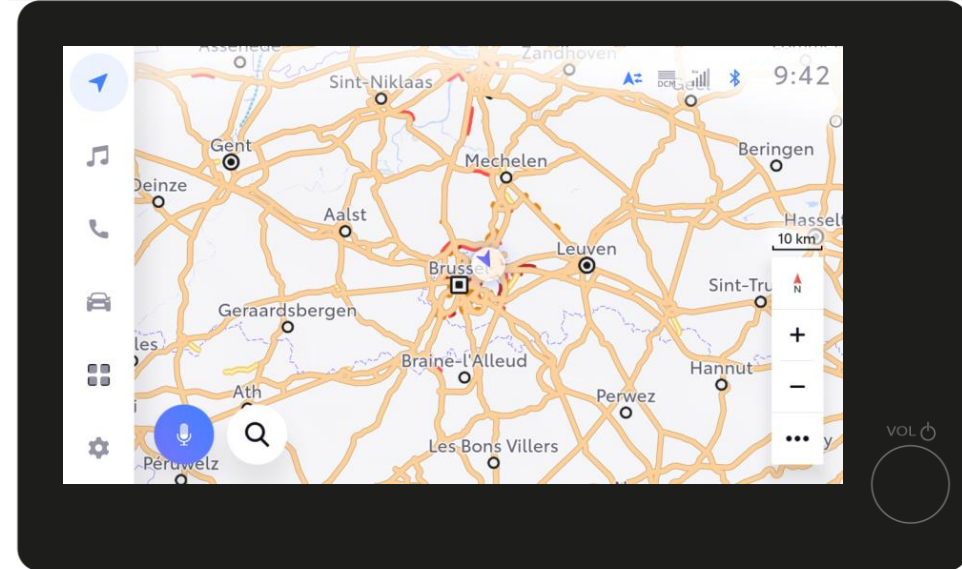

You can enable Apple CarPlay / Android Auto at this point to get access to your phone applications.



EVERY FEATURE COUNTS

*Connected Services are continually improving, therefore visuals and app screens in this guide may slightly differ from those seen in your MyToyota App.

